

#### Features

- ✦ High Tensile Strength
- ✦ High External/Internal Burst/Collapse Strength
- ✦ Metal to Metal Seals with Double O-Ring Backup
- ✦ 2-4 Gauge Carrying Capacity
- ✦ Capability to Measure Internal or External Pressures
- ✦ Custom sizes available upon request

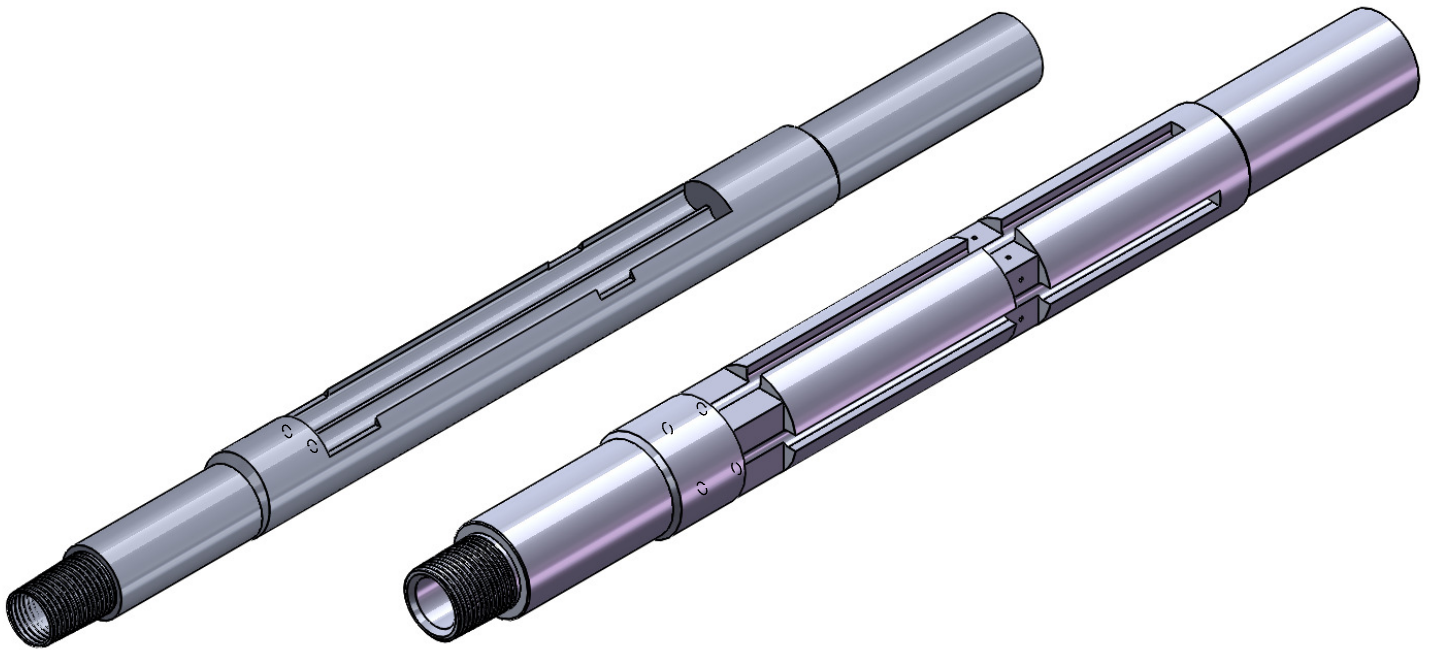

4140 Gauge Carrier					
Burst	Collapse	Tensile	Thread	Carries	Part No.
15,000 psi	15,300 psi	198,000 lbs	2-7/8" EJE	2 x 0.75" Gauges	104228
15,000 psi	15,300 psi	198,000 lbs	2-7/8" Premium	2 x 0.75" Gauges	104229
10,150 psi	10,500 psi	202,000 lbs	3-1/2" EJE	2 x 1.25" Gauges	104230
10,150 psi	10,500 psi	202,000 lbs	3-1/2" Premium	2 x 1.25" Gauges	104231

Accessory Type	Part No.
Polaris Carrier Adapter - Internal	103013
Polaris Carrier Adapter - External	103014
Polaris Carrier Adapter Redress Kit	103017